

INSTRUCTION MANUAL

30 DEGREES

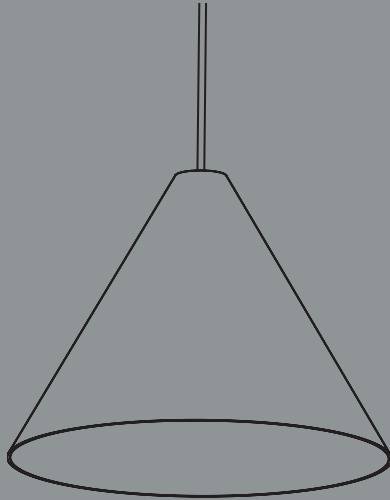

By Johan Van Hengel

HAY

INTRODUCTION

30 Degrees is a lightweight shade made of laminated oak veneer. The seamless surface is achieved by aligning the ends of semicircular veneer sheets at a 30 Degrees angle, so the inside cone and internal angle is always 30 Degrees. The layering of the conical veneer creates a solid shade that is opaque and characterized by its harmonious woodgrain pattern. Rich in tactility, the series express a natural elegant aesthetic. All shades are sealed with a matt lacquer and supplied with a moulded locator fitting, which levels and supports the shade when suspended. 30 Degrees suspension light is available in conjunction with Cord Set.

NOTE

If you are using this shade in conjunction with the HAY Cord Set, please follow the instructions that have been provided with it for safe installation.

TECHNICAL DATA

This product is fitted with an E27 bulb fitting. We would recommend the following bulb specifications for 30 degrees: E27, 10.5-13W, 2800k Warm White (A series).

HAY will not accept any responsibility for any accidents or injuries that occur due to the use of incorrect bulbs.

ATTENTION

Ensure that the power supply to the circuit has been turned OFF before installing the product. In some countries, electrical installations must be carried out by an authorised electrician/contractor; please check with your local authority

for guidance. The product must not be modified in any way. HAY accepts no responsibility for any products that have been modified or tampered with.

CARE AND MAINTENANCE

Ensure that the power supply has been turned OFF before cleaning this product. The product can be cleaned with a soft damp cloth. Do not use alcohol or any other solvents to clean the product and avoid using abrasive or rough

sponges. If the trailing cable on this product becomes damaged, it should be replaced immediately by qualified personnel to ensure there is no risk of injury.



PARTS

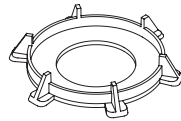
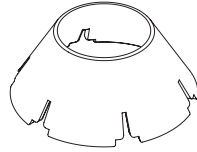
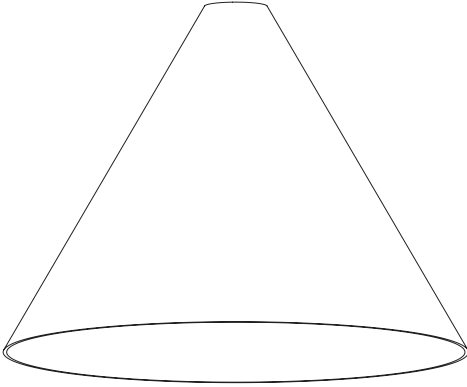

1.

Unscrew and remove the lower shade ring from the bulb holder.

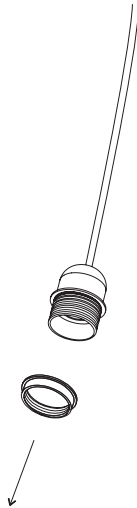

2.

Place the shade over the bulb holder.

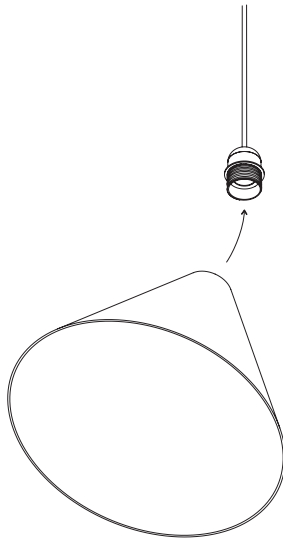

3.

Place the plastic shade support on the bulb holder and replace the lower shade ring to fix it in place. The plastic conical insert that the shade support connects with stops the shade from being dislodged during use for e.g. cleaning.

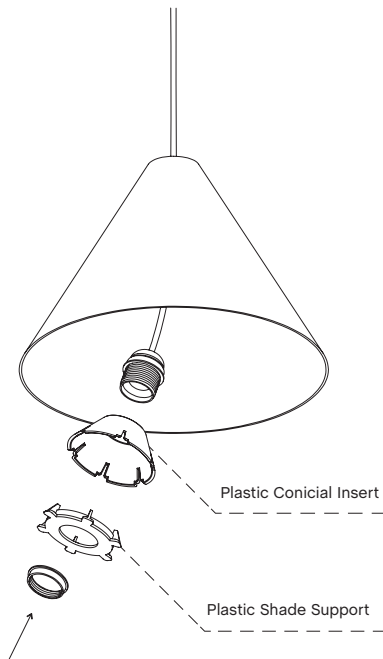

4.

Place the shade over the bulb holder,
ensuring it is parallel to the floor.

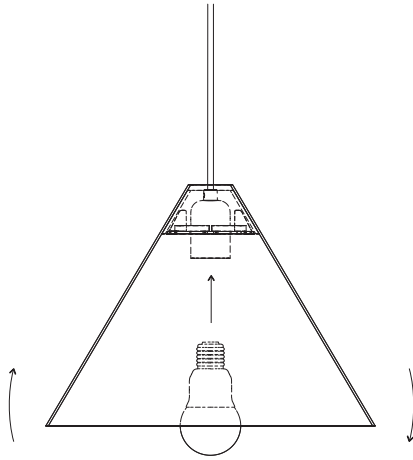

Havnen 1 8700 Horsens Denmark

+45 4282 0282 / hay@hay.com

HAY